

Datasheet PR0126-C

Article-No.: 50298

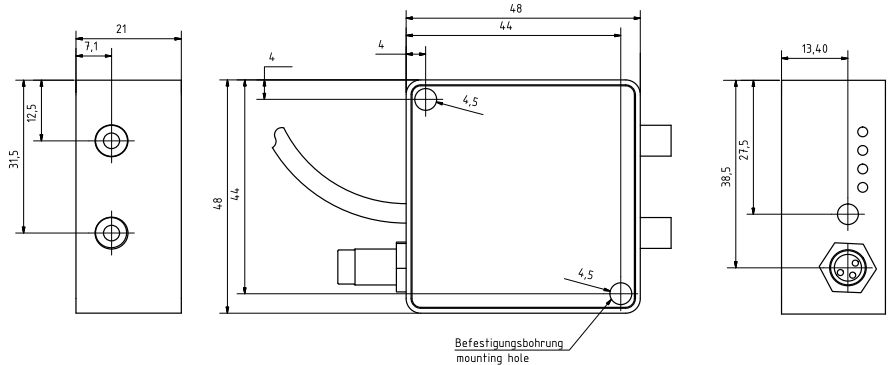

Tolerance of Measure: Unless otherwise noted in drawing, tolerances are specified with ± 0.1 and dimensions are specified in mm.



Safety and Warning Instructions

The system is not designed and constructed for use as a safety-critical component in systems and machines in general, nor for particular use in medical applications. Use is not permitted in these areas. Assembly, installation and maintenance are to be performed by trained personnel only.



Safety and Warning Instructions Light Source

Do not look into the light source for a long-time during operation. May be harmful to the eyes. DIN EN 62471 risk group 2. Never intentionally point the light beam from the light source or the light beam of the connected fiber optics into your own eyes or into the eyes of other people. If you look directly into the light beam of the light source or the light beam of the connected fiber optics, the high luminosity of the light source can cause glare to the eyes. If a light beam hits the eyes, close the eyes immediately and move the head out of the light beam. No optically highly focused instruments may be used to view the light beam.

Pin Assignment Serial Interface

Pin assignment of the 3-pole M8 connector.

1	TxD
3	GND
4	RxD

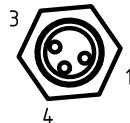

Pin Assignment Connection Cable

Pin assignment of the 5-pole connection cable.

Color	Meaning
Brown	Power supply 12 V to 26 V DC
White	Power supply 0 V
Green	Output 1 (product number, binary coded)
Yellow	Output 2 (product number, binary coded)
Grey	Output 3 (product number, binary coded)

LED Indicator

LED	State	Meaning
Out 1	off	Output 1 inactive
	on, yellow	Output 1 active
Out 2	off	Output 2 inactive
	on, yellow	Output 2 active
Out 3	off	Output 3 inactive
	on, yellow	Output 3 active
Power	off	No power supply.
	on, green	Power supply present, system ready.
	flashing, green	System sending and/or receiving data over the communication interface.

Technical Data

Power supply	12 V to 26 V DC, 80 mA
Output load	≤ 10 mA
Saturation voltage	≤ 3 V
Switching frequency	500 Hz
Products	up to 7 binary coded via 3 outputs
Outputs	24 V DC / 30 mA push/pull
Spectral range	380 nm to 780 nm
Output	XYZ, CIEL*a*b*, ΔE
Resolution	8 gain steps a 12 Bit
Color resolution	$< 0.1 \Delta E$
Repeat accuracy	$< 0.5 \Delta E$
Light source	LED white
Variant	Push/Pull
Interface	RS232
Connection cable length	1 m
Material case	Aluminum coated
IP Code	IP54
Operating temperature	10 °C to 55 °C
Operating humidity	35 % to 85 % relative humidity
Storage temperature	-10 °C to 60 °C
Weight	approx. 120 g